



©1996 KAZUKI TAKAHASHI  
©2011 NAS • TV TOKYO

**2013 Yu-Gi-Oh! World Championship**

**Bally's Hotel and Casino**

**Las Vegas, NV**

**August 10 – 11, 2013**

# Hotel Information

## Hotel Location:

Bally's Hotel and Casino  
3645 S. Las Vegas Blvd  
Las Vegas, NV 89109  
(877) 603-4390

Bally's is located in the center of the Las Vegas Strip. The hotel is directly connected to the Paris Hotel and is across the street from the Bellagio hotel. Bally's is also a stop on the Las Vegas monorail that runs across the strip with stops at Sahara, Las Vegas Hotel and Casino (LVH) Las Vegas Convention Center, Harrah's, Flamingo and MGM Grand. Bally's is conveniently 3.0 miles away from the McCarran International Airport

All players, staff and guests will be staying at the Bally's Hotel and Casino.

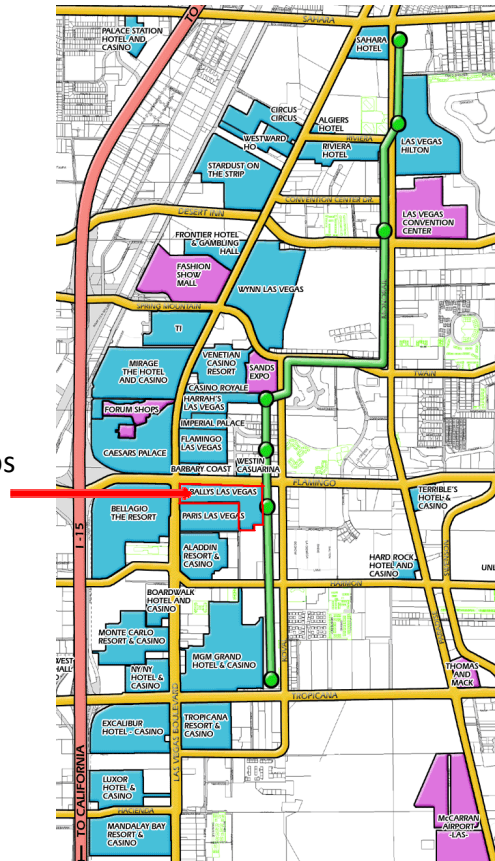

## Arrival

The closest International Airport is McCarran International Airport (LAS). Meet service will be arranged for all players that need assistance to go from the Airport to the Hotel. A representative will meet you at the baggage claim area and provide shuttle service to the hotel.

Once you arrive at the hotel, please proceed to the check-in counters, our staff will be happy to assist you with the check-in process. Please note that all hotel room and taxes have been prepaid, but a credit or debit card will need to be presented at time of check in to cover incidentals, regardless of whether you intend on using any incidentals. After checking in to your room, please make sure to check-in with the Tour Desk staff in the Director's room so that we can provide you with information for the weekend. We will also be taking your photo at this time to use throughout the weekend. If you need shuttle service to the airport for your

departure, please inform the Tour Desk staff. Shuttle service will be provided for individuals who are leaving on **Monday, August 12<sup>th</sup>** only. If you are leaving on a different date please utilize the taxi service to the airport.

## Tour Desk

The tour desk will be staffed by both English and Japanese speaking staff members. Please visit the tour desk for any questions that you may have for the event. Please note that any ruling questions will be answered during the open question session with the judges on Friday before the Welcome Dinner

August 8, 2013 (Thursday): 9 AM – 10 PM

August 9, 2013 (Friday): 9 AM – 10 PM

August 10, 2013 (Saturday): 7 AM – 7 PM

August 11, 2013 (Sunday): 7 AM – 7 PM

August 12, 2013 (Monday): 7 AM – 7 PM

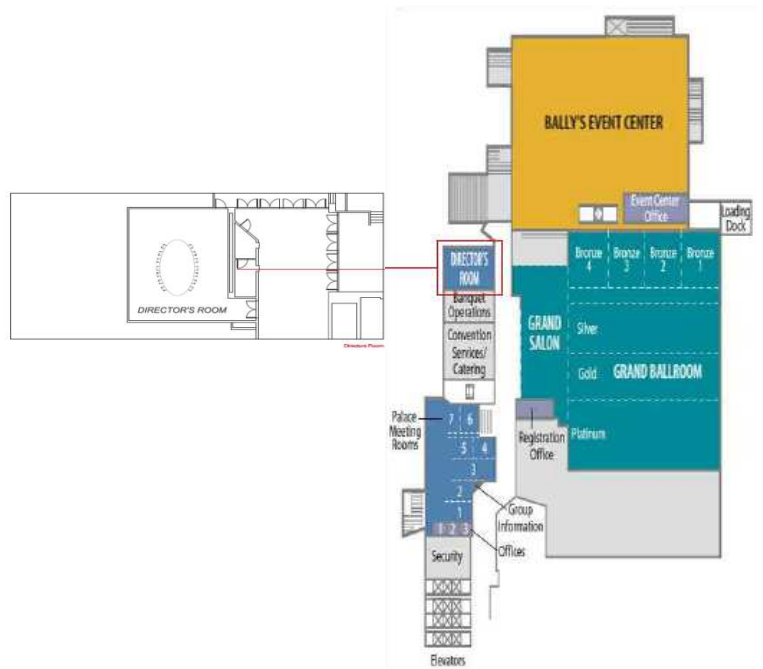

## World Championship Venue Location

The 2013 World Championship will be split in two (2) different rooms at the Bally's Hotel and Casino. The World Championship stage will be located in the Bronze and Silver Ballroom while the Public Events and carnival games will be located in the Bally's Event Center. There will be one single entrance into the World Championship with signs directing to either the Main Event or the Public Events/Carnival area.

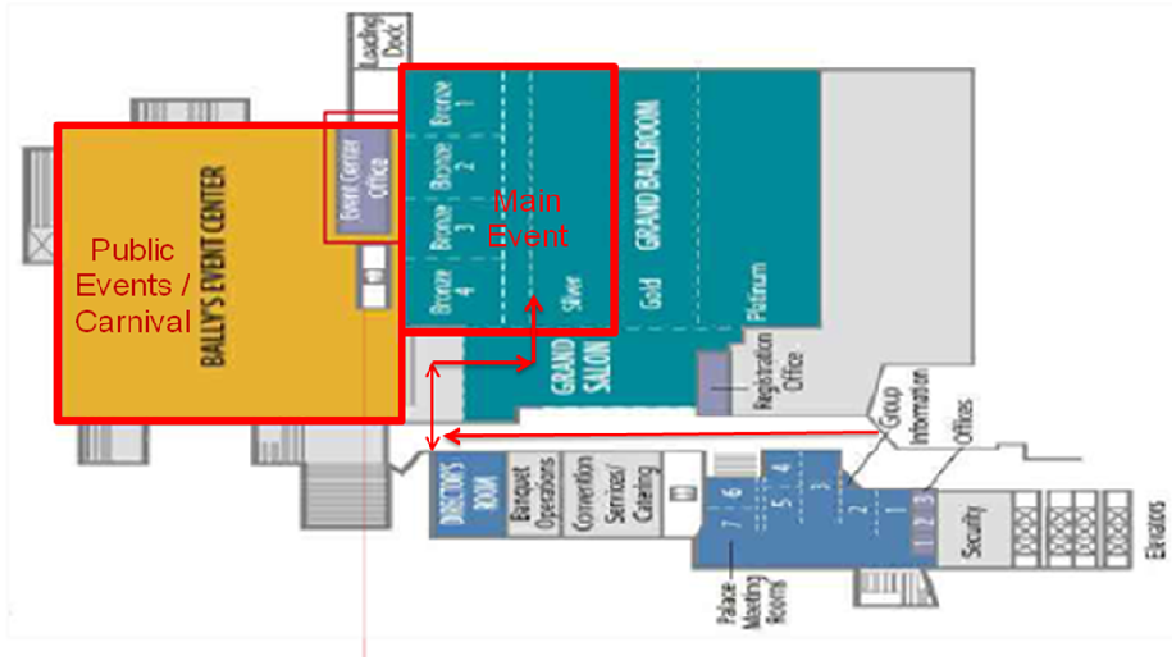

## Card Shop Tour – Friday

A shuttle bus will be provided to visit a local card shop and major retailers in the Las Vegas area. Players can hop on and off at anytime that the shuttle buses are running. However, please make sure to be on the final bus back to Bally’s. The time table for the shuttle is as follows:

Tour Stops:

- Stop 1: Bally’s Hotel and Casino
- Stop 2: Game World Associates
- Stop 3: Walmart
- Stop 4: Target
- Stop 5: Bally’s Hotel and Casino

Bally's	Game World	Walmart	Target	Bally's
10:00 AM	10:15 AM	10:25 AM	10:40 AM	11:00 AM
11:00 AM	11:15 AM	11:25 AM	11:40 AM	12:00 PM
12:00 PM	12:15 PM	12:25 PM	12:40 PM	1:00 PM
1:00 PM	1:15 PM	1:25 PM	1:40 PM	2:00 PM
2:00 PM	2:15 PM	2:25 PM	2:40 PM	3:00 PM
3:00 PM	3:15 PM	3:25 PM	3:40 PM	4:00 PM
	4:15 PM	4:25 PM	4:40 PM	5:00 PM

## Judge Q & A Session – Friday 5:00 PM

Judges will be available at the Tour Desk from 5:00 PM to 6:30 PM to answer any questions that you may have regarding rules and regulations for the tournament. Please note that deck collection will happen at the beginning of the Welcome Dinner. Please visit the Tour Desk if they have any questions regarding your deck list during the Judge Q&A time.

## Welcome Dinner – Friday 7:00 PM

The Welcome Dinner will be located inside the Bally's Hotel and Casino on the 26<sup>th</sup> floor of the North Tower in Skyview room 5 & 6. Dinner will begin at **7:00 PM - 10:00 PM** and will be buffet style. The dinner menu will be as follows:

Chicken Noodle Soup  
Field Greens with Champagne Vinaigrette  
Classic American Potato Salad  
Southern Style Fried Chicken  
Fried Catfish Filet  
Meatloaf with Mushroom Gravy  
Buttered Corn on the Cob  
Yukon Gold Mashed Potatoes  
Macaroni Cheese  
Mini Cheesecakes  
Mini Carrot Cakes  
Mini Warm Apple Pies

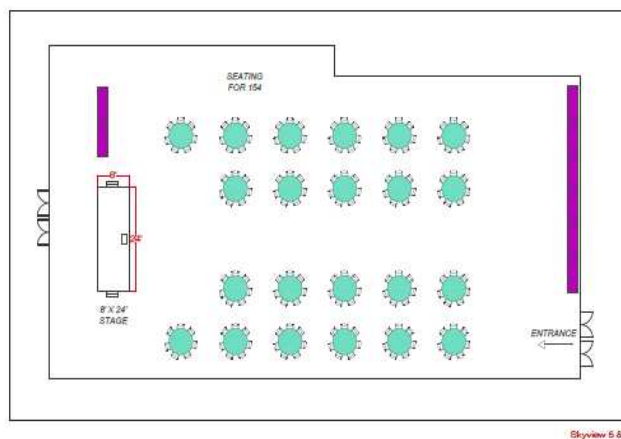

Gifts and Jerseys will be handed out at the Welcome Dinner. In addition, **ALL DECK LISTS WILL BE COLLECTED AT THE BEGINNING OF DINNER.**

Each player will be asked to take a picture at the Green Screen booth during the dinner to create their personalized 2013 Yu-Gi-Oh! World Championship Token Card. This token card will be provided to you the next morning before competition begins.

## **Non-Top 8 Player – Sunday Activities**

Individuals who do not advance to the second day of competition will have various activities that they can take part in.

The public events area will also feature carnival based games. These games include a Basketball Challenge, a Bean Bag Toss, Bingo and a Giant Card Challenge.

In addition, we will separate players into two (2) groups and ask that you take part in the “Duel a Champion” public event. You will be asked to be a “Master” and Duel individuals that want to Duel a National Champion. This will be in a King of the Hill format. Each group will Duel for 1:30 to 2 hours.

# Event Schedule

## Friday:

9:00 AM	Tour Desk Open 9:00 AM - 10:00 PM	
10:00 AM		Card Shop Tour 10:00 AM - 4:55 PM
11:00 AM		
12:00 PM		
1:00 PM		
2:00 PM		
3:00 PM		
4:00 PM		
5:00 PM		Judge Q &A 5:00 PM - 6:30 PM
6:00 PM		
7:00 PM		Welcome Dinner 7:00 PM - 10:00 PM
8:00 PM		
9:00 PM		
10:00 PM		
11:00 PM		

## Saturday:

		Public Events	World Championship	Dragon Duel World Championship
7:00 AM	Tour Desk Open 7:00 AM - 7:00 PM			
			8:15: Meet in Hotel Lobby	8:15: Meet in Hotel Lobby
8:00 AM			8:15: Deck Check	8:15: Deck Check
			Rules Explanation / Rehearsal 8:15 - 9:15 AM	Rules Explanation / Rehearsal 8:15 - 9:15 AM
9:00 AM			9:30 AM: Doors Open	9:30 AM: Doors Open
			Opening Ceremonies 9:30 -10:00 AM	Opening Ceremonies 9:30 -10:00 AM
10:00 AM			Round 1 (Swiss Draw) 10:00 - 11:00 AM	Round 1 (Swiss Draw) 10:00 - 11:00 AM
11:00 AM			Round 2 (Swiss Draw) 11:15 - 12:15 PM	Round 2 (Swiss Draw) 11:15 - 12:15 PM
12:00 PM			Lunch in Breakroom 12:15 - 1:10 PM	Lunch in Breakroom 12:15 - 1:10 PM
1:00 PM			Round 3 (Swiss Draw) 1:10 - 2:10 PM	Round 3 (Swiss Draw) 1:10 - 2:10 PM
2:00 PM			Round 4 (Swiss Draw) 2:25 - 3:25 PM	Round 4 (Swiss Draw) 2:25 - 3:25 PM
3:00 PM			Round 5 (Swiss Draw) 3:40 PM - 4:40 PM	
4:00 PM			4:40 - 5:00 PM: Day 1 Results	4:40 - 5:00 PM: Day 1 Results
5:00 PM			Announcement for Day2 5:00 - 5:30 PM	Announcement for Day2 5:00 - 5:30 PM
6:00 PM				



# Sunday

		Public Events	World Championship Top 8	World Championship Non-Top 8	Dragon Duel World Championship Top 8	Dragon Duel World Championship Non-Top 8		
7:00 AM	Tour Desk Open 7:00 AM - 7:00 PM							
8:00 AM			8:00: Meet in Hotel Lobby		8:00: Meet in Hotel Lobby			
			8:15: Deck Check		8:15: Deck Check			
9:00 AM			Greetings and Rule Explanation 8:15 - 9:00 AM	9:00: Meet in lobby	Greetings and Rule Explanation 8:15 - 9:00 AM	9:00: Meet in lobby		
			9:30 AM: Doors Open	9:30 AM: Doors Open	9:30 AM: Doors Open	9:30 AM: Doors Open		
			Opening Comments 9:30 - 10:00 AM	Opening Comments 9:30 - 10:00 AM	Opening Comments 9:30 - 10:00 AM	Opening Comments 9:30 - 10:00 AM		
10:00 AM		Public Events 10:00 - 4:00 PM		Round 1 10:00 - 11:00 AM		Round 1 10:00 - 11:00 AM		
11:00 AM				Semi Finals Game 11:15 - 12:15 PM	Group 1 Duel a Champion 10:30 - 12:30 PM	Semi Finals Game 11:15 - 12:15 PM	Group 1 Duel a Champion 10:30 - 12:30 PM	
12:00 PM				3rd/4th Place Game 12:30 - 1:30 PM		Lunch 12:15 - 1:30 PM		
1:00 PM				Lunch 1:30 - 3:00 PM	Live Duel 1:30 PM - 2:00 PM	Live Duel 1:30 PM - 2:00 PM	Live Duel 1:30 PM - 2:00 PM	
2:00 PM					Group 2 Duel a Champion 2:00 - 3:30 PM	3rd / 4th Place Game 2:00 PM - 2:45 PM	Group 2 Duel a Champion 2:00 - 3:30 PM	
3:00 PM						Dragon Duel Final 3:00 - 3:45 PM		
4:00 PM					Finals Game 4:00 - 4:45 PM	Watch Finals Game 4:00 - 4:45 PM	Watch Finals Game 4:00 - 4:45 PM	Watch Finals Game 4:00 - 4:45 PM
5:00 PM					Awards Ceremony 4:45 - 5:00 PM	Awards Ceremony 4:45 - 5:00 PM	Awards Ceremony 4:45 - 5:00 PM	Awards Ceremony 4:45 - 5:00 PM
6:00 PM				Interview for Top 4 5:00 - 6:00 PM		Interview for Top 4 5:00 - 6:00 PM		

## **Departure**

Individuals who have signed up for shuttle service to the airport should meet at the Tour Desk. Please make sure you check out of your hotel and pay any incidentals before the meet time at the Tour Desk.

## **Emergency Contact**

If at any time during your stay you have any issues and the tour desk is not open, please contact Tak Shimada at 310-945-7570.